

WK - WLK Series

Wafer/Lug
Butterfly valves
300-600 Class

- Series
- WK3
 - WK3/M
 - WLK3
 - WLK3/M
 - WK6
 - WK6/M
 - WLK6
 - WLK6/M

Identification of the valve parts

Pos.	Description Item	Q.ty
1	Body	1
2	Disc	1
3	Seal seat retainer	1
*4	Seal seat	1
5	Stem	1
6	-	-
7	Gland	2
8	Thrust washer	1
*9	Stem seal	2
10	Pins	2
11	Seal seat retainer screw	*
12	Gland screw	*
13	Bushing	4
14	Thrust washer	1
15	Seeger ring	2
16	Flange	1
*17	Seal seat gasket	1
18	Feather	1

(*) Normally recommended spare parts
(-) Related to valve size

WK/M Section view

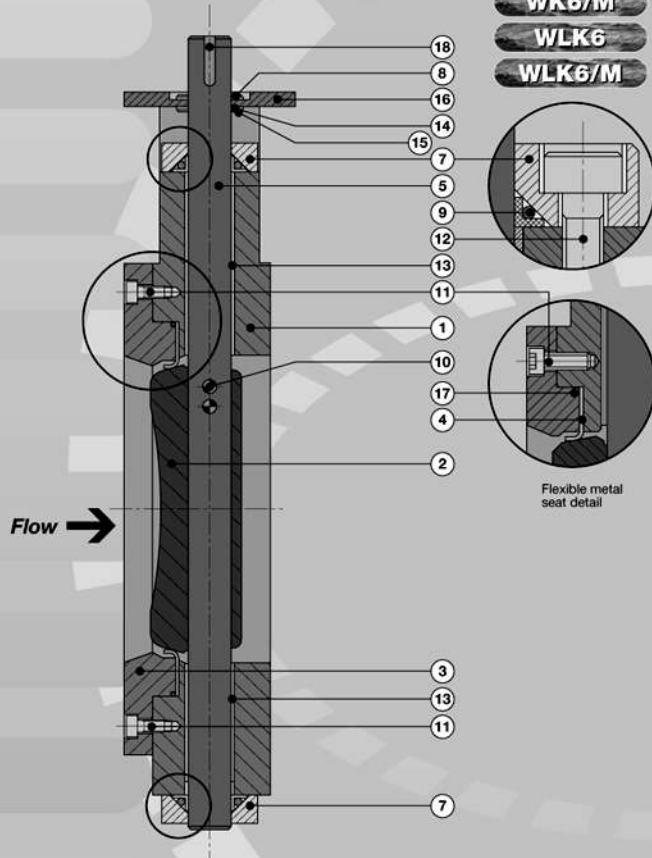

Double eccentric detail

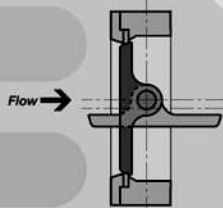

Wafer type Assembled views

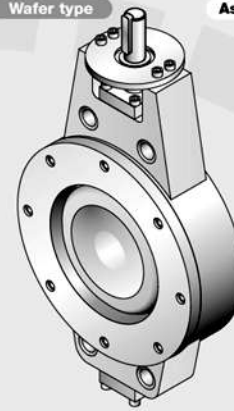

Lug type

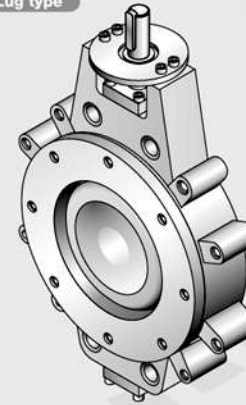

Assembly view

WK3
WK3/M

